

Continental SAM

DN 165 DH 203 IN 50

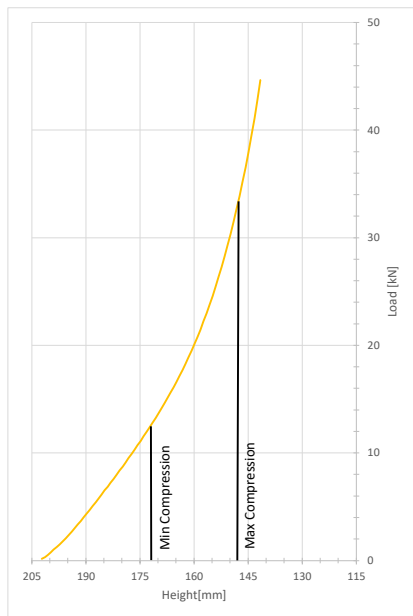

Compression [%]	15	20	22.5	25	27.5
Load [kN]	12.4	18.3	22.2	27.3	33.8
Height [mm]	172	162	157	152	147
Spring Rate [kN/m]	522	700	895	1157	1523
Effective Deflection [mm]	24	26	25	24	22
Natural Frequency [Hz]	3.3	3.1	3.2	3.3	3.4
Maximum OD [mm]	179	184	187	189	192
Weight [Kg]	3.96				

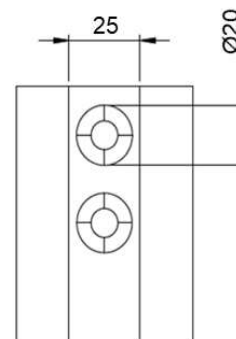
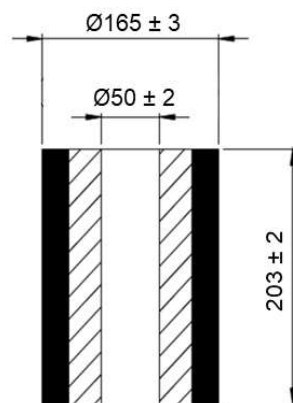

Continental SAM is the solution for spring replacement and vibration isolation.

With its resistant, durable and economical design it helps to cut costs in nearly all industrial applications.

- › better working conditions due to a dramatically reduced noise level
- › reduced downtimes
- › compact design
- › high load-bearing capacity
- › reliable even in damp or corrosive conditions
- › maintenance-free
- › safe due to the absence of moving parts
- › reliable even in extreme temperatures (-40°F to 167°F, -40°C to +75°C)